

List of Works

Shinro Ohtake

The National Museum of Modern Art, Tokyo
November 1 (Tue.) – February 5 (Sun.), 2023

* This list is common to the Tokyo, Ehime, and Toyama venues.

* The work numbers agree with those in the catalogue and the galleries, but the order of display does not necessarily agree with the work numbers.

* Works with no entry in the collection column belong to the artist, courtesy of TAKE NINAGAWA.

* The exhibits may be changed for certain reasons.

Self/Other

001
MON CHERI: A Self-Portrait as a Scrapped Shed

2012 / Dimensions variable

002
"Black," "Shiden-Kai"

1964 / 27×38 cm

003
Study from Diane Arbus "Identical Twins, Roselle, N.J., 1967"

1973 / 33.3×24.2 cm

004
Self-Portrait

1973 / 80.4×65.2 cm

005-1
Betsukai

1974 / 11×7.5 cm each

005-2
Utashinai

1975 / 11×7.5 cm each

006
Pensive Self-Portrait

1974.4.22 / 43.1×30.2 cm

007
Stillbirth

1974.5.28 / 24.5×35.7 cm

008
Sky and Road, Betsukai

1981 / 91×72.5 cm

009
Autumn on the Nishibetsu River, Betsukai

1974 / 31.5×48.3 cm

010
UK 77

1977–78 / 11×7.5 cm each

011
Arrival Night Self-Portrait, Regent's Park Hotel

1977.5.3 / 23×14.1 cm

012
City at My Feet, Alexander Park

1977 / 14.5×18 cm

013
7th of May, 1979

1979 / 40.7×32 cm

The Collections of Jehan Chu and Alan Lo

014
From Portraits by Richard Avedon

1979 / 54×38.8 cm

015
MICHELLE: FIND THIS MAN

1978 / 74.5×42.7 cm

016
Self-Portrait for Oil Painting Degree at Musashino Art University

1980 / 55.9×48.5 cm

017
Man and Tree

1978 / 44×28×5.5 cm

018
Strato

1975 / 91.5×116.7 cm

019
B.E.

1979 / 51.5×23.6 cm

020
Artists Only

1978 / 42×59.5 cm

021
Highway 61

1975 / 48×57.5 cm

022
Man

1975 / 77.4×53.2 cm

023
Man

1974–75 / 165×83×53 cm

Toyama Prefectural Museum of Art and Design

024
Mr. Peanut

1978–81 / 91×72.5 cm

Private Collection

025
Yellow Angel Serving Tea

1982 / 162×162×10 cm

Fukutake Foundation

026
EZMD V

1985 / 91×72.7 cm

027
EZMD I

1984 / 194×162 cm

028
Torso and Guitar

1988 / 54×39.5×12 cm

The National Museum of Modern Art, Tokyo

029
Michiko Photographed

1984 / 91×72.7 cm

030
J.J.

1986.10.14 / 91×73 cm

031
Tofuya Tonkatsu

2015.9.15 / 53×45.5 cm

032
Still Life after Matisse

2007.4.14 / 45.5×53 cm

033
Boris Karloff II

2000 / 70×50 cm

034
Exposure / Man with a Pistol

2004.12.9–2005.1.10 / 70.2×50 cm

035
Exposure / Man

2004.11 / 70.5×50 cm

036
Portrait of Andy Warhol

1996 / 26.7×21.4 cm

037
Tornado Alley 1

1992 / 43.5×32 cm

038
After A. Jarry

1995.3 / 38×28.2 cm

039
Kingsway Studio, New Orleans

1994.9.15 / 26.7×19.4 cm

040
Takemitsu

2007.10.23 / 25.7×18.2 cm

041
D. Hockney Drawing for Lithograph at Bradford

1984 / 25.7×37 cm

042
Mr. Toru Takemitsu and Russell Mills

1990.10.8 / 14.3×7.2 cm

217
Shadow I

1987 / 195×195 cm

Fukutake Foundation

218
Ubu Suspended

1994 / 123.5×68×20.2 cm

222
Tokyo-Kyoto Scrap-Images

1984 / 203.4×1622 cm

Fukutake Foundation

223
Echo of Thunder

1985–87 / 225×166×13 cm

Fukutake Foundation

224
Nail Fetish

1986 / 207×122.5×12 cm

Fukutake Foundation

225
Bay I

1990 / 207×452×15 cm

226
Bow Shadow

1990 / 170×302×15 cm

Memory

043
Mnemoscape 32

2020–21 / 66×40×23 cm

Fujimoto Harukiyo Collection

044
Mnemoscape 14

2020 / 100×70×12 cm

Shirai Collection

045
Nairobi II

1984 / 117×117 cm

046
Shapes of Memories

1984 / 108.2×90.1×5.5 cm

OKETA COLLECTION

047
Retina (Strobo I)

1992 / 100×70 cm

048
Time Memory / Edge 6

2015 / 30.3×21×1.5 cm

049
Time Memory / Edge 27

2016 / 100.5×71 cm

050
Time Memory / Fault 10

2015 / 91×73×9.5 cm

Wendy Lee Collection

051
Time Memory 12

2011 / 100×70 cm

052
Abandoned Zone/At Window

2019 / 47×29.5 cm

Private Collection

053
Abandoned Zone

2019 / 100×70×11 cm

054
New Boots

1987 / 162×162 cm

055
Genoa I

1985 / 190×185 cm

056
Piece of Memory

2005 / 40×90×37 cm

057
Head

1988 / 111×57×31 cm

219
Santiago

1985 / 194×386 cm

Toyama Prefectural Museum of Art and Design

220
Oku-Kei 14

2018 / 153×133×9.2 cm

221
Time Memory 30

2018 / 200×150×10 cm

Time

058
Emit

1979 / 40×15.7 cm

059
Four Chances

1984 / 162×162 cm

060
Red Snake, Green Snake

1984 / 162×162 cm

061
Mombasa II

1983 / 162×162 cm

062
Tochka I

1988 / 190.2×185 cm

063
Time Memory / Projection 2

2017 / 244×40×40 cm

064
Time Memory 31/Projection

2019 / 200×150×20 cm

065
Time Memory 32/Projection

2019 / 200×150×20 cm

066
Retina/Boundary Scene 7

1990–2015 / 230.5×170.5×10.5 cm

Taguchi Art Collection / Taguchi Art Foundation

067
Retina/Energy Track

1990–2020 / 148×110×8 cm

Private Collection, Hamburg, Germany

068
Retina/Dark Fever 8

1990 / 55.7×45.5 cm

- 069**
Retina/Solar Wind 1
1990–2020 / 230×170×10 cm
UESHIMA COLLECTION
- 070**
Time Memory / Fault 8
2015 / 91×73×11.5 cm
Private Collection
- 071**
Traces of Sounds 2
2010 / 29.6×21 cm
Private Collection
- 072**
Time Memory / Feedback
2015 / 42×42×96 cm
-
- Transposition
-
- 073**
Explorer
1985 / 100×70 cm
- 074**
Nairobi VI
1983 / 78.4×62.2×2.7 cm
- 075**
Exposure / Nozoki-iwa 4
2003.9.24–9.25 / 70.5×50.3 cm
- 076**
About Japan
1979 / 36.5×14.7 cm
- 078**
The Bridge Koumonbashi, Kanazawa
1985 / 172×172.5 cm
- 079**
New Florida, Nairobi
1983 / 162×162 cm
Yoshida Minako Collection
- 080**
Elephant II
1985 / 150×150 cm
- 081**
Catholicism with Pagan
1986 / 190×185 cm
Shirai Collection
- 082**
Impression of the Fall
1984 / 162×162 cm
- 083**
My Life in Nairobi
1984 / 121.5×121.5 cm
Fukutake Foundation
- 084**
Teaching of Islam I
1983 / 117×117 cm
- 085**
Teaching of Islam II
1983 / 117×117 cm
- 086**
Pond II
1984 / 162×292 cm
- 087**
British Car I
1977 / 18.7×18.8 cm
- 088**
Laugh
1979 / 37.5×27.8 cm
- 089**
Map, Central
1980 / 16.8×12 cm
Shin WATARI Collection
- 090**
Show Window, Istiklal Cad
1994 / 26.7×19.4 cm
- 091**
Blue Sheet Harem, Topkapi
1994 / 26.7×19.4 cm
- 092**
Daylong Scream, Shinjuku / Niigata / Kumamoto
1999 / 46.1×70.2 cm
- 093**
Highland Girls, Inawashiro / Koriyama
1998.12.11–12.16 / 49.9×70.3 cm
- 094**
Heavenly Maiden Ascendent, Naruto / Shinjuku
1999 / 50.2×70.4 cm
- 095**
Interchange, Shinjuku / Honolulu
1997 / 50.1×70.3 cm
- 096**
New Chanell
1998 / 179×73.5×16.6 cm
- 097**
ZYAPAIORAMA X
1998 / 60×45×16.6 cm
- 098**
ZYAPAIORAMA XI
1998 / 60×45×16.6 cm
- 099**
ZYAPAIORAMA / Shinjuku
1997 / 131×94×8 cm
- 100**
Blue Shift / Frankenstein
1978 / 54.5×39.5 cm
- 101**
ZYAPAIORAMA / Tokyo II
1997 / 300×210×10 cm
Fukutake Foundation
- 102**
Wall, London
1978 / 53×43 cm
- 103**
Sprayed Wall
2003.10.19 / 72.6×60.8 cm
- 104**
Pink Box
1980 / 18.6×23.7×14.1 cm
- 105**
Retina Table (Ambleside)
1991–92 / 173.5×212×114 cm
-
- Dreams / Retina
-
- 106**
Garage
1984 / 162×162 cm
- 107**
Red Soldiers
1984 / 91.5×64.5 cm
- 108**
Memphis Board
1989 / 46.2×64×28.2 cm
- 109**
Retina No. 1 (Landscape 1)
1991 / 91×73 cm
- 110**
Retina No. 8 (Landscape 8)
1991 / 91×73 cm
- 111**
Retina (Shifting on the Red)
1991–92 / 43×27.5×6 cm
- 112**
Retina (Falling in the Brown)
1991–93 / 120×56×60 cm
- 113**
Mississippi Blue
1989 / 268×271×4 cm
The Collections of Jehan Chu and Alan Lo
- 114**
Memphis #2
1989 / 252×180×4 cm
The Collections of Jehan Chu and Alan Lo
- 115**
Retina (Left Eye)
1990–91 / 314×150 cm
- 116**
Retina (Right Eye)
1990–91 / 314×150 cm
- 117**
Retina #1 (White Nile)
1988–90 / 250×180.5×7.5 cm
The Collections of Jehan Chu and Alan Lo
- 118**
Retina (Crevasse)
1990 / 300×230×11 cm
- 119**
Retina (Window)
1989 / 60×34.5 cm
- 120**
Black and White #7
1989 / 20.5×13.9 cm
Private Collection
- 121**
Black and White #9
1989 / 21.4×14.8 cm
- 122**
Black and White #10
1989 / 21.2×13.7 cm
Private Collection
- 123**
Black and White #11
1989 / 20.8×14.9 cm
- 124**
Black and White #15
1989 / 21.9×13.8 cm
Private Collection
- 125**
Black and White #16
1989 / 21×14.1 cm
Private Collection
- 126**
Retina / Blue Infinity
1989 / 100×74.2×10 cm
- 127**
Retina #31 (Candle Smoke)
1990–91 / 240×181×5.3 cm
- 128**
Retina #35 (Map)
1991 / 100×74×10 cm
- 129**
Mannequin 2
1985 / 18×12.9 cm
- 130**
Viewfinder Images
1988–90 / 25.4×20.3 cm
- 131**
Viewfinder Images III
1988–90 / 24.4×20.3 cm
- 132**
Small Retina
1988–90 / 26.7×20.6 cm
- 133**
Viewfinder Images VIII
1988–90 / 35.6×20.5 cm
- 134**
Retina/On Sand Dunes 3
1990–2020 / 148×110×8 cm
Private Collection, Hamburg, Germany
- 135**
Retina/Time Shadows 4
1990–2015 / 150×110×8 cm
-
- Scrapbook
-
- 227**
Scrapbook #1 / London
1977 / 21.5×13.2×3.6 cm
- 228**
Scrapbook #2 / London
1977–78 / 29.2×23.5×5.8 cm
- 229**
Scrapbook #3 / London
1977–78 / 22.5×17.6×4.6 cm
- 230**
Scrapbook #4 / Tokyo
1979 / 19×13.7×3.9 cm
- 231**
Scrapbook #5 / Tokyo
1979.8.1– / 26.3×20.1×5.6 cm
- 232**
Scrapbook #6 / Tokyo / Hong Kong
1979.8–9 / 26.3×19.8×5.1 cm
- 233**
Scrapbook #7 / Tokyo / Hong Kong
1979.9 / 18.8×14.1×5.3 cm
- 234**
Scrapbook #8 / Tokyo / Hong Kong
1979.10 / 26.5×20.1×4.7 cm
- 235**
Scrapbook #9 / Tokyo / Hong Kong
1979.11.11–12.14 / 29.9×23×4.6 cm
- 236**
Scrapbook #10 / Tokyo
1979.12–1980.1 / 26.4×20.3×6.6 cm
- 237**
Scrapbook #11 / Tokyo
1980.1.1–1.31 / 19×15.8×7.6 cm
- 238**
Scrapbook #12 / Tokyo
1980.2.18–3.10 / 18.8×14.2×4.2 cm
- 239**
Scrapbook #13 / Tokyo
1980.3 / 26.7×20.5×7.2 cm
- 240**
Scrapbook #14 / London
1980.5 / 30.5×21.2×3.4 cm
- 241**
Scrapbook #15 / London
1980.7 / 30.6×21.1×3.2 cm
- 242**
Scrapbook #16 / Moscow / London / Paris / Hong Kong
1980.9 / 20.8×15.7×11.4 cm
- 243**
Scrapbook #17 / Hong Kong / Tokyo
1980.9.30–12.14 / 26.6×19.9×7.7 cm
- 244**
Scrapbook #18 / Tokyo
1980.12–1981.2 / 26.4×20.6×5.4 cm
- 245**
Scrapbook #19 / Tokyo
1981.2.16–3.18 / 26.2×19.3×4.6 cm
- 246**
Scrapbook #20 / Tokyo
1981.4.14–5.19 / 26.5×20.1×5.1 cm
- 247**
Scrapbook #21 / Tokyo
1981.4.20–6.2 / 26.5×19.3×6.2 cm
- 248**
Scrapbook #22 / Tokyo
1981.7.3–7.31 / 26.4×20.5×7.8 cm

- 249**
Scrapbook #23 / Tokyo
1981.8.3–9.16 / 26.6×19.7×7.8 cm
- 250**
Scrapbook #24 / Tokyo
1981.9.19–11.17 / 26.4×21.8×10.6 cm
- 251**
Scrapbook #25 / Tokyo
1981.11.18–12.31 / 30.6×22.2×5.9 cm
- 252**
Scrapbook #26 / Tokyo / Hong Kong
1982.1.1–2.4 / 26.5×20.9×4.3 cm
- 253**
Scrapbook #27 / Tokyo
1982.2.10–3.10 / 26.6×20.6×8.8 cm
- 254**
Scrapbook #28 / Tokyo
1982.5.10–8.10 / 26.5×21.7×7.1 cm
- 255**
Scrapbook #29 / Tokyo / Hong Kong
1983.2–3 / 29.4×26.1×7.3 cm
- 256**
Scrapbook #30 / Tokyo
1983.2–3 / 29.8×26.2×6.7 cm
- 257**
Scrapbook #31 / Tokyo / New York
1983.5–9 / 29.4×26.5×5.8 cm
- 258
Scrapbook #32 / New York / Tokyo
1983.5.20–7 / 29.3×26.2×7.4 cm
- 259**
Scrapbook #33 / London / Africa (Kenya)
1983 / 55.8×22.3×15.3 cm
- 260**
Scrapbook #34 / New York
1983.6 / 26.5×20.7×6.7 cm
- 261**
Scrapbook #35 / Tokyo
1982.4–1983.9 / 26.7×20×6.4 cm
- 262**
Scrapbook #36 / Tokyo
1983.8 / 26.5×20.5×5.6 cm
- 263**
Scrapbook #37 / Tokyo
1983.10.8–1984.1.31 / 26.6×20.8×4.8 cm
- 264**
Scrapbook #38 / Tokyo
1984.1.1–4 / 26.7×19.9×5.8 cm
- 265**
Scrapbook #39 / Tokyo / London
1984.7.17– / 26.5×19.8×5.2 cm
- 266**
Scrapbook #40 / Tokyo / London
1984.7 / 26.5×21.2×10.2 cm
- 267**
Scrapbook #41 / Tokyo
1984.9 / 29.2×26.2×6.2 cm
- 268**
Scrapbook #42 / Tokyo / London
1984.9.4–11.20 / 26.1×21.3×9.7 cm
- 269**
Scrapbook #43 / Berlin
1984.12–1988.7.23 / 26.6×21.3×11.4 cm
- 270**
Scrapbook #44 / Bali
1985.7.8– / 26.4×19.2×4.7 cm
- 271**
Scrapbook #45 / Bali
1985 / 26.5×19.9×5.2 cm
- 272**
Scrapbook #46 / Tokyo / Berlin / Hokkaido
1985.1.1–3.31 / 48.6×21×8.8 cm
- 273**
Scrapbook #47 / Tokyo
1990.12–1991.2 / 24.1×20×10.6 cm
- 274**
Scrapbook #48 / Tokyo / Uwajima
1991.9.29– / 31.3×24.8×22.6 cm
- 275**
Scrapbook #49 / Uwajima
1992.11 / 29.8×25.7×17.7 cm
- 276**
Scrapbook #50 "Retina / Silver Cheese" / Uwajima
1992 / 67.1×56.8×9.4 cm
- 277**
Scrapbook #51 / Morocco
1993 / 26.6×22.3×11.2 cm
- 278**
Scrapbook #52 / Uwajima
1993–95 / 31.2×27.1×17.2 cm
- 279**
Scrapbook #53 / Istanbul
1994–95 / 44.2×26.4×17.3 cm
- 280**
Scrapbook #54 / Uwajima
1994–95 / 29.9×23.9×19.8 cm
- 281**
Scrapbook #55 / Uwajima
1994–96 / 39.5×30.6×55.4 cm
- 282**
Scrapbook #56 / Uwajima
1996–97 / 37.8×34.6×16.4 cm
- 283**
Scrapbook #57 / Uwajima
1997.4.4–1999.12.15 / 39.8×32.4×13.8 cm
- 284**
Scrapbook #58 / Uwajima
1998 / scrapbook: 34.9×28×12.2 cm;
appendix: 2.9×23×41.2 cm
- 285**
Scrapbook #59 / Uwajima / London
1999.12.13–2000.8 /
scrapbook: 29.5×25.7×14.8 cm;
guitar: 68.5×21.2 cm
- 286**
Scrapbook #60 / Uwajima
2000 / 37.6×27.1×9.1 cm
- 287**
Scrapbook #61 / Uwajima
2002.4.16–10.3 / 31×26.9×13.6 cm
- 288**
Scrapbook #62 / Uwajima
2002.11.2–2003.1.2 / 29.9×24.6×15.9 cm
- 289**
Scrapbook #63 / Uwajima
2003.7.2–12.13 / 34.2×27.2×16.1 cm
- 290**
Scrapbook #64 / Uwajima
2003–05 / 50.6×54×62.2 cm
- 291**
Scrapbook #65 / Uwajima
2005.3–2010.5.20 / 54×47×80 cm
- 292**
Scrapbook #66 / Uwajima
2010–12 / 72×96×129 cm
- 293**
Scrapbook #67 / Uwajima
2014 / 47×47.5×74 cm
- 294**
Scrapbook #68 / Uwajima
2014.2.14–2016.5.25 / 41×39×33 cm
- 295**
Scrapbook #69 / Uwajima
2016.5.26–2017.5.31 / 36.7×57.5×32 cm
- 296**
Scrapbook #70 / Uwajima
2017.6.26–2018.8.31 / 36.5×47.5×23 cm
- 297**
Scrapbook #71 / Uwajima
2018.9.10–2021.1.31 / 33×85.5×40.4 cm
- Layer / Stratum
- 136**
Retina (New Tong of Tangier I)
1992–93 / 216×212×82 cm
- 137**
Retina (Memories of Falling Silver)
1994 / 274×187×26 cm
- 138**
Retina (Wire Horizon, Tangier)
1990–93 / 274×187×20 cm
The National Museum of Modern Art,
Tokyo
- 139**
Buglayer / Portrait of 0 and 1
2000–01 / 220.6×470×14 cm
- 140**
LONDON/HONCON 1980 X
1986 / 109.3×79.1 cm
Fukutake Foundation
- 141**
Wallpaper
1978–79 / 162×162.5 cm
- 142
Poppy / Sound Shadow I
2008 / 216×194×4 cm
- 143**
Poppy / Sound Shadow II
2008 / 125×105×8.5 cm
The Museum of Art, Ehime
- 144**
Oku-Kei 19
2018 / 153×133×9.2 cm
- 145**
Tokyo—Puerto Rico
1986 / 198.5×194 cm
Fukutake Foundation
- 146**
The Melancholy of a Queer Bull
1987–88 / 227×200×30 cm
- 147**
Family Tree
1986–88 / 265×265×20 cm
Sezon Museum of Modern Art
- 148**
Dream / Apollinaire, Macao
1980 / 16.8×11.9 cm
- 149**
Central, Hong Kong (September 15)
1980 / 16.8×11.7 cm
Shin WATARI Collection
- 150**
Interior, Causeway Bay
1980 / 16.5×12.5 cm
Shin WATARI Collection
- 151**
Chi Fu Fa Yuen
1980 / 16.8×12.1 cm
Shin WATARI Collection
- 152**
Love Love Love, King's Road, Hong Kong
1980 / 16.8×12 cm
- 153**
Siemens Building from Window, Causeway Bay
1980 / 24.1×17.7 cm
- 154**
TARGET
1979 / 54.5×41.2 cm
- 155**
Retina (Empire)
1979 / 54.5×41.2
- 156**
Retina Map #83
1991 / 45×30.5×10.5 cm
- 157**
Retina Map #58
1991 / 45×30.5×10.5 cm
Private Collection
- 298**
Satsutaba #1
2021 / 20×14.5 cm
- 299**
Satsutaba #2
2021 / 20×14.5 cm
- 300**
Satsutaba #3
2021 / 20×14.5 cm
- 301**
Satsutaba #4
2021 / 20×14.5 cm
- 302**
Satsutaba #5
2021 / 20×14.5 cm
- 303**
Satsutaba #6
2021 / 20×14.5 cm
- 304**
Satsutaba #7
2021 / 20×14.5 cm
- 305**
Satsutaba #8
2021 / 20×14.5 cm
- 306**
Satsutaba #9
2021 / 20×14.5 cm
- 307**
Satsutaba #10
2021 / 20×14.5 cm
- 308**
ULTRAMAN
1978 / 19.4×15.1 cm
- 309**
LOWER EAST SIDE
1978 / 17.8×13.8 cm
- 310**
FORTUNE
1978 / 29.7×21.1 cm
- 311**
NO. 4
1978 / 29.7×21.1 cm
- 312**
SHOGUN AND JAZZ
1978 / 29.8×21.1 cm
- 313**
BOOKS
1978–79 / 10×6.7 cm
- 314**
BOOKS
1978–79 / 6.7×5.1 cm

- 315**
BOOKS
1978–79 / 10×6.7 cm
- 316**
BOOKS
1978–79 / 10×6.7 cm
- 317**
BOOKS
1978–79 / 6.9×5.1 cm
- 318**
BOOKS
1978–79 / 10.8×7.2 cm
- 319**
BOOKS
1978–79 / 7.1×5.1 cm
- 320**
BOOKS (PSYCHELIC MAGAZINE)
1978–82 / 10×6.7 cm
- 321**
BOOKS
1978–79 / 10×6.7 cm
- 322**
BOOKS
1978–79 / 10.7×7 cm
- 323**
BOOKS
1978–79 / 7.1×5.1 cm
- 324**
BOOKS
1978–79 / 10.7×7 cm
- 325**
BOOKS
1978–79 / 6.9×5.1 cm
- 326**
BOOKS
1978–79 / 6.9×5.1 cm
- 327**
BOOKS
1978–79 / 6.9×5.1 cm
- 328**
BOOKS
1978–79 / 6.9×5.1 cm
- 329**
BOOKS
1978–79 / 6.9×5.1 cm
- 330**
Boy's Own
1978–79 / 10.7×7 cm
- 331**
NA
1978–79 / 10.7×7 cm
- 332**
Tanalith
1978–79 / 10.7×7 cm
- 333**
See without Glasses
1978–79 / 10.7×7 cm
- 334**
NOW FOR YOU DOGFACE
1978–79 / 10.6×7 cm
- 335**
Tay Teo Chuan—pencil drawings 1980
1980 / 17.8×15.2 cm
- 336**
Tay Teo Chuan—pencil drawings 1980
1980 / 17.8×15.2 cm
- 337**
JANUARY, 1970
1980 / 21×15.6 cm
- 338**
Man Cow Scale
after 1980 / 18.8×14 cm
- 339**
Tokyo Scrapbook 81, #1
1981 / 15.5×10.8 cm
- 340**
Tokyo Scrapbook 81, #2
1981 / 15.5×10.8 cm
- 341**
SHINRO OHTAKE I
1982 / 4.4×3.8 cm
- 342**
SHINRO OHTAKE II
1982 / 4.8×3.5 cm
- 343**
BOOK
1982 / 6.4×4.6 cm
- 344**
Psychedelic Magazine, prototype for LTD
1982 / 10.9×7.2 cm
- 345**
APOLLO
1983 / 17.5×11.8 cm
- 346**
RAIN, RAIN, RAIN
1984 / 3.7×2.5 cm
- 347**
19
1984 / 25.4×18.2 cm
- 348**
19
1984 / 25.4×18.2 cm
- 349**
19
1984 / 25.4×18.2 cm
- 350**
19
1984 / 25.4×18.2 cm
- 351**
19
1984 / 25.4×18.2 cm
- 352**
19
1984 / 25.4×18.2 cm
- 353**
19
1984 / 25.4×18.2 cm
- 354**
IN AFRICA
1984 / 19.9×13.7 cm
- 355**
SAME OLD STORY
1984 / 22.3×17.3 cm
- 356**
19
1984 / 11.8×8.9 cm
- 357**
GENTS
1984 / 15×10.5 cm
- 358**
FRIENDS
1984 / 15×10.5 cm
- 359**
LEAVES
1984 / 15×10.5 cm
- 360**
GOLD FISH
1984 / 5.5×4.5 cm
- 361**
SOME FRIENDS
1984 / 5.5×4.5 cm
- 362**
NOTTING HILL
1984 / 17.2×16.7 cm
- 363**
LONDON/HONCON #1
1986 / 13×9.3 cm
- 364**
LONDON/HONCON #2
1986 / 13×9.5 cm
- 365**
Beauty Box
1986 / 7×6.2 cm
- 366**
EZMD
1986 / 17.1×13.8 cm
- 367**
Small Dreams #101
1991 / 12.8×9.2 cm
- 368**
Small Dreams #102
1991 / 12.8×9.2 cm
- 369**
Small Dreams #103
1991 / 12.8×9.2 cm
- 370**
Small Dreams #104
1991 / 12.8×9.2 cm
- 371**
Small Dreams #105
1991 / 12.8×9.2 cm
- 372**
Small Dreams #106
1991 / 12.8×9.2 cm
- 373**
Small Dreams #107
1991 / 12.8×9.2 cm
- 374**
Small Dreams #108
1991 / 12.8×9.2 cm
- 375**
Small Dreams #109
1991 / 12.8×9.2 cm
- 376**
Small Dreams #110
1991 / 12.8×9.2 cm
- 377**
Small Dreams #111
1991 / 12.8×9.2 cm
- 378**
Small Dreams #112
1991 / 12.8×9.2 cm
- 379**
Tiny Dreams #1
1990 / 9×6.5 cm
- 380**
Tiny Dreams #2
1990 / 9×6.5 cm
- 381**
Tiny Dreams #3
1990 / 9×6.5 cm
- 382**
Tiny Dreams #4
1990 / 9×6.5 cm
- 383**
Tiny Dreams #5
1990 / 9×6.5 cm
- 384**
Yukan Uwajima Nichinichi (Evening Uwajima Daily), January 1993
1993 / 11.3×7.6 cm
- 385**
Yukan Uwajima Nichinichi (Evening Uwajima Daily), February 1993
1993 / 11.3×7.6 cm
- 386**
Yukan Uwajima Nichinichi (Evening Uwajima Daily), March 1993
1993 / 11.3×7.6 cm
- 387**
Yukan Uwajima Nichinichi (Evening Uwajima Daily), April 1993
1993 / 11.3×7.6 cm
- 388**
UBU ROI
1993 / 36.4×26 cm
- 389**
JARRY UBU
1993 / 21×14.8 cm
- 390**
PORTRAITS/RICHARD AVEDON BY SHINRO OHTAKE 18TH JULY 1979
1994 / 18.2×14 cm
- 391**
PORTRAITS/RICHARD AVEDON BY SHINRO OHTAKE 18TH JULY 1979
1994 / 18.2×14 cm
- 392**
PRAGUE PARIS HAUTERIVES
1992 / 14×21 cm
- 393**
Yukan Uwajima
1990 / 16.8×9.4 cm (full size:16.8×99.7 cm)
- 394**
DUB-HEI FIRST ENGLAND TOUR
2002/16.2 x 13.5cm(fullsize:16.2 x 108cm)
- 395**
LTD./no.1
2002 / 24.5 x 19.2 cm
- 396**
Waikiki Dreams
2003 / 4.7×5.5 cm
- 397**
Rainbow Dreams
2003 / 3×5 cm
- 398**
Silver Dreams
2003 / 3×2.9 cm
- 399**
PRINTED MATTER<America/Japan>1989
1990 / 31.8×22.5×4 cm
- 400**
Drawing Book 1984–1993 Jan.
1993 / 31.5×24×6.4 cm
- 401**
Happy Birthday 1992
1992 / 33.5×24.3×3 cm
- 402**
2002 Night and Day
2002 / 59.7×53.8×10.6 cm
- 403**
Americans
1989.2.1-3.3 / 13.5×11.4cm 27×20.7cm (drawings) 28.6×22.8 cm (case)
- 404**
X+Y=LOVE—a tribute to Japanese popular music
1995 / 40.4×30.4×3 cm

405 MOUSCAPEGOD: 0 and 1 / Fifteen Electrified Recollections 2001 / 73×57.3×4 cm	173 Telecas Sam (Imaginary Musician 6) 2005.11.8 / 44.7×32.3 cm	196 PUZZLE PUNKS, <i>BUDUB</i> 1996 / 12.5×14.1 cm	216 <i>Mnemoscape 0</i> 2022.1.31 / 212×161×16 cm
406 <i>DREAMS 1988</i> 1988 / 42.5×31.7 cm	174 <i>BUDUB I</i> 1996 / 31.5×31.5 cm	197 JUKE/19., <i>JUKE/19. [1978–1982]</i> 1996 / 13.7 x 14.2 x 3.7cm	077 <i>Uwajima Station</i> 1997/ 190×90×180 cm each *Installed at the terrace (2nd floor)
407 <i>IRANIAN TALES</i> 1988 / 42.5×31.7 cm	175 <i>BUDUB II</i> 1996 / 31.5×31.5 cm	198 JUKE/19., <i>19/19 [1978–1983]</i> , first pressed edition 2003 / 12.5×14 cm	
408 <i>Nihonkei</i> 2000 / 31.4×24×4.2 cm	176 <i>LINEPIPE</i> 1996 / 31×22.5 cm	199 JUKE/19., <i>19/19 [1978-1983]</i> , standard edition 2003 / 12.9×15.4 cm	
409 <i>AT Ianta 1945+50</i> 1996 / 22×14.5 cm	177 <i>Radio Head Surfer</i> 1994-95 / 82.6×33.4×18.6 cm	200 PUZZLE PUNKS, <i>PUZOO</i> 2006 / 12.5×14.1 cm	
410 <i>THE HARD VIBES/NIBBLING SPIDER</i> 1995 / 38.5×31 cm	178 <i>Cut Hands Vision II</i> 1995 / 91×73 cm	201 Kazuhisa Uchihashi + Dub-Hei & New Chanell, <i>UCHI-DUB</i> 2006 / 12.5×14 cm	
411 <i>Hawaii Blue (tabloid)</i> 2022 (original 1999) / 40.5×28.5 cm	179 <i>TUH</i> 1995 / 91×73 cm	202 Dub-Hei & New Chanell, <i>Found Heat / Da</i> 2007.10.31 / 13.1×13.2 cm	
Sound	180 <i>Electrocity II</i> 2003 / 100.3×71.1 cm	203 PUZZLE PUNKS, <i>PUZZPUNN</i> 2022.11.1	
158 <i>Guitarist</i> 1991.2.7 / 44×23.9×3 cm	181 <i>Sound Indoors</i> 2000 / 38.7×27 cm	204 JUKE/19. Performance view at Hosei University, December 8, 1981 1981.12.8	
159 <i>DEVO</i> 1980 / 72.6×90.7 cm	182 <i>Traces of Sounds 9</i> 2010 / 29.6×21 cm	205 Original Work for JUKE/19. Poster 1981 / 103×73 cm	
160 <i>Erik Satie</i> 1983–84 / 26.3×32.6 cm	183 <i>Black Wall</i> 2015 / 205×170 cm	206 <i>BUDUB</i> 1995 / 30.2×30.2 cm	
161 <i>Guitarist I</i> 1975.5 / 25.5×36.6 cm	184 JUKE/19., <i>JUKE/19.</i> 1980.12 / 31.1×31 cm	207 <i>Kluba Cupol</i> , performance view, Notre Dame Hall, London, 1980 1980.6.19 /	
162 <i>Interior 2</i> 1979 / 84.5×59.7 cm	185 JUKE/19., <i>JUKE/19.</i> 1980.12 / 31.1×31 cm	208 Newspaper notice for live event at Notre Dame Hall, London 1980 /	
163 <i>Interior 3 (Back Water)</i> 1979 / 85.2×60.8 cm	186 JUKE/19., <i>19</i> 1981.2 / 17.5×38 cm	209 Instructions from Russell Mills for Dome's debut live performance at Notre Dame Hall, London, 1980 1980 /	
164 <i>The Singer</i> 1984 / 72.7×60.6 cm	187 JUKE/19., <i>NINETY-SEVEN CIRCLES</i> 1981.3 / 31×31 cm	210 <i>At the Notre Dame Hall, London '80 II</i> 1980 / 30.5×36.8 cm	
165 <i>Musician</i> 1985 / 100×70 cm	188 JUKE/19., <i>PIECES</i> 1981.12 / 31×31 cm	211 <i>D. A. F. (Deutsch Amerikanische Freundschaft)</i> 2004.1 / 80.5×57.4 cm	
166 <i>Brain and Heartbeat</i> 1995 / 37×27.4 cm	189 JUKE/19., <i>SOUND TRACK</i> 1982.9 / 31×31 cm	212 ONLY CONNECT (Russell Mills/Shinro Ohtake), <i>Untitled</i> 1988 / 17.7 x 17.7 cm	Document video Videos installed at the corridor (2nd floor)
167 <i>ZYAPAIORAMA I</i> 1995 / 39.4×31 cm	190 JUKE/19., <i>MUSIC BY "19" TAKEN FROM THE ALBUM 'SOUND TRACK'</i> 1982 / 18×18 cm	213 <i>Rubbish Men</i> 1987 / 405×405×20 cm Museum of Contemporary Art Tokyo	<i>Haisha</i> 15:37 <i>MECON</i> 7:13 <i>Needle factory</i> 10:16 <i>Naoshima Bath "I ♥ 湯"</i> 7:58 <i>Dub-Hei & New Chanell</i> 11:23
168 <i>ZYAPAIORAMA VII</i> 1997 / 106×39.5×8.5 cm	191 JUKE/19., <i>EZMD</i> 1987 / 21.2×15.3×1.3cm	214 <i>Teaching of Islam III</i> 1985–87 / 225×170.5×100 cm Fukutake Foundation	Document video on Scrapbooks 25:38 21世紀のBUG男 画家 大竹伸朗 89:00
169 <i>Waikiki I</i> 2000.9.10–9.17 / 70.7×49.8 cm	192 JUKE/19., <i>EZMD</i> , standard edition 1991 / 12.5×13.9 cm	215 <i>Dub-Hei & New Chanell</i> 1999 / (stage) 450×530×310 cm (control booth) 234×190×150 cm Fukutake Foundation	
170 <i>Waikiki II</i> 2000.9.10–9.17 / 70.7×50.2 cm	193 JUKE/19., <i>EZMD</i> , limited edition 1991 / 12.5×13.9 cm		
171 <i>Waikiki III</i> 2000.9.10–9.17 / 70.7×49.8 cm	194 Shinro Ohtake + Yamantaka EY3, <i>PIPELINE—Yamantaka Diary</i> 1995 / 12.7×14.2 cm		
172 <i>Puzzle Punks 2006</i> 2005.12.5–2006.1 / 69.8×49.8 cm	195 PUZZLE PUNKS, <i>BUDUB</i> 1996 / 31×31 cm		

大竹伸朗展

Shiro Ontake

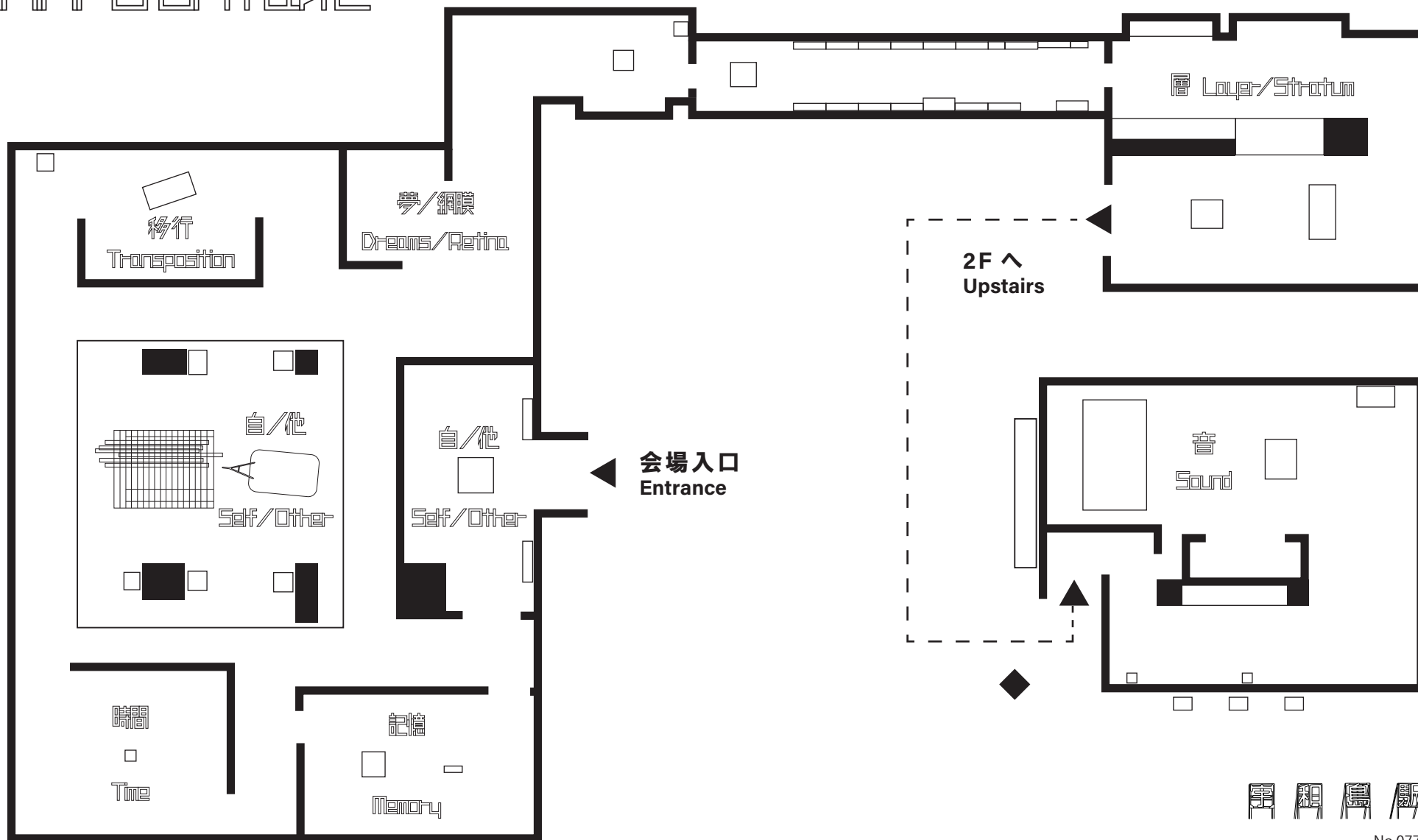

貸 租 展 場

No.077